

PROPERTY DETAILS: 27 HOWE STREET
 LEGAL DESCRIPTION: Pt 7 DP 37860
 TOTAL AREA: 2393m²
 COMPRISED IN: CT NA2074/65

PROPERTY DETAILS: 35A HOWE STREET
 LEGAL DESCRIPTION: Lot 2 DP 203433
 TOTAL AREA: 3295m²
 COMPRISED IN: CT NA132A/442

PROPERTY DETAILS: 35 HOWE STREET
 LEGAL DESCRIPTION: Lot 1 DP 49542
 TOTAL AREA: 3688m²
 COMPRISED IN: CT NA1B/842
 ZONING: MAIN RESIDENTIAL

Notes:
 1. Final areas and dimensions are subject to final Land Transfer Survey
 2. This plan has been prepared specifically for use in this application only

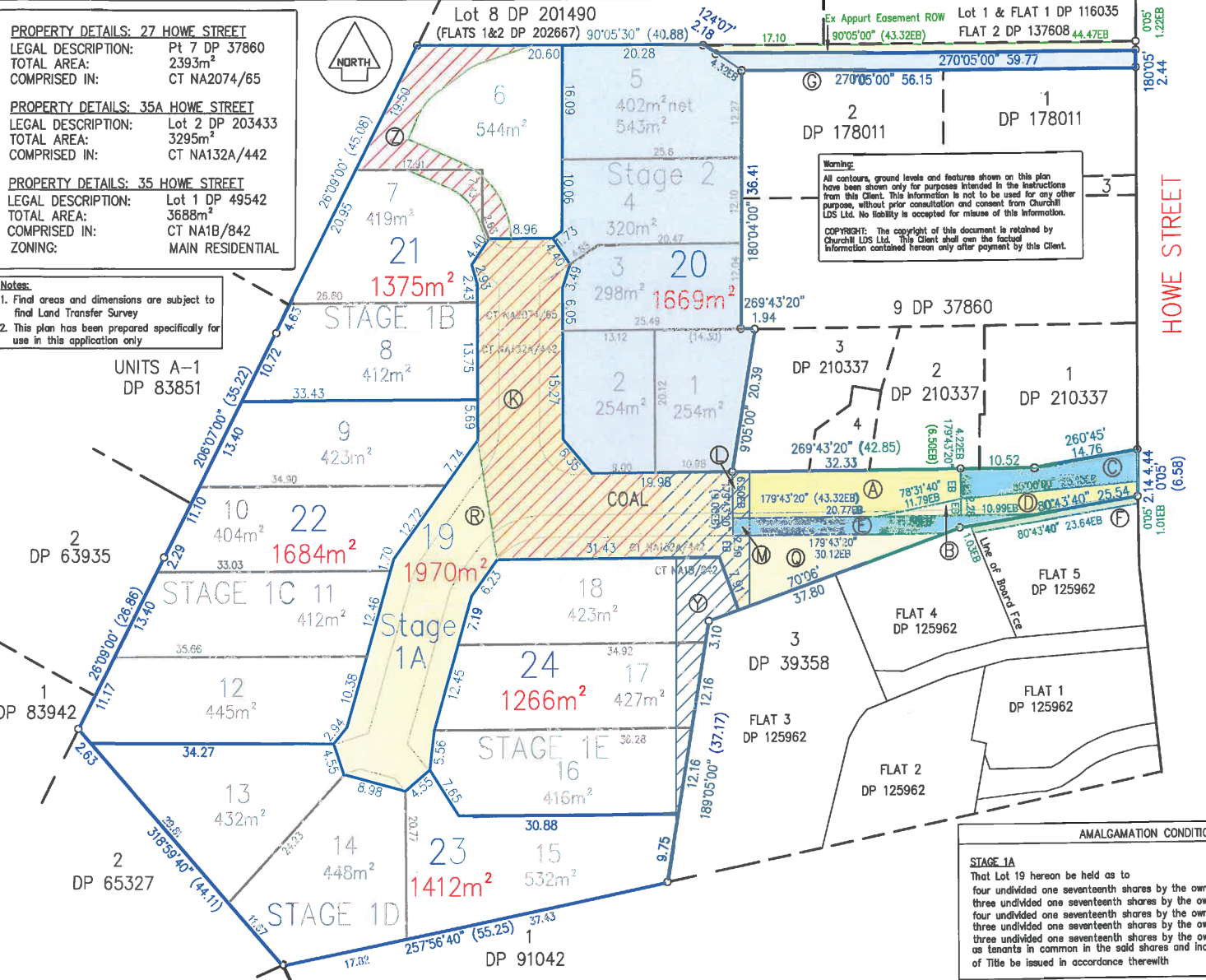

Warning:
 All contours, ground levels and features shown on this plan have been shown only for purposes intended in the instructions from this Client. This information is not to be used for any other purpose, without prior consultation and consent from Churchill LDS Ltd. No liability is accepted for misuse of this information.
 COPYRIGHT: The copyright of this document is retained by Churchill LDS Ltd. The Client shall own the factual information contained hereon only after payment by this Client.

MEMORANDUM OF EASEMENTS

PURPOSE	SHOWN	SERVIENT TENEMENT	DOMINANT TENEMENT
Pedestrian Right of Way	(F)	Lot 3 DP 39358	Lots 20 - Lot 24 Hereon Lot 1 DP 210337 Lot 2 DP 210337 Lot 3 DP 210337
Right of Way	(E)(M)	Lot 19 hereon	Lot 1 DP 210337 Lot 2 DP 210337 Lot 3 DP 210337

MEMORANDUM OF EASEMENT IN GROSS

PURPOSE	SHOWN	SERVIENT TENEMENT	GRANTEE
Right to Drain Water	(Z)	Lot 21 hereon	Auckland Council
	(Y)	Lot 24 hereon	
	(K)(L)(M)	Lot 19 hereon	

PROPOSED EASEMENTS IN GROSS

PURPOSE	SHOWN	SERVIENT TENEMENT	GRANTEE
Right of Way	(A)(B)	Lot 19 Hereon	Vector Limited
Right to Convey Electricity	(C)(D)		
Right of Way	(E)(K)		Vector Limited
Right to Convey Gas	(F)(M)		
Right of Way	(G)(R)	Chorus New Zealand Limited	

EXISTING EASEMENTS

PURPOSE	SHOWN	SERVIENT TENEMENT	CREATED BY
Right of Way	(A)(B)	Lot 19 Hereon	EC D651856.8
	(C)(D)		
	(L)(E)		
Right of Way	(C)	Lot 20 Hereon	T683508
Right of Way	(C)(D)	Lot 19 Hereon	T D651856.7
Right of Way	(E)	Lot 19 Hereon	T D651856.8

EXISTING EASEMENTS TO BE SURRENDERED

PURPOSE	SHOWN	SERVIENT TENEMENT	CREATED BY
Right of Way	(E)	DP 203433	T D651856.8

AMALGAMATION CONDITIONS

STAGE 1A
 That Lot 19 hereon be held as to four undivided one seventeenth shares by the owners of Lot 20 hereon; three undivided one seventeenth shares by the owners of Lot 21 hereon; four undivided one seventeenth shares by the owners of Lot 22 hereon; three undivided one seventeenth shares by the owners of Lot 23 hereon; three undivided one seventeenth shares by the owners of Lot 24 hereon; as tenants in common in the said shares and individual Certificates of Title be issued in accordance therewith

R AUCKLAND COUNCIL
 This plan shall be read as part of
 Resource Consent No: 48406
 Sheet: 2 of 39

Churchill LDS
 SURVEYORS • ENGINEERS • DESIGNERS

P.O. Box 64 246
 Botany
 Auckland 2163
 Tel: (09) 273 4182
 Fax: (09) 273 4309
 Email: admin@clds.co.nz

**SUBDIVISION PLAN - STAGE 1A
 (LOTS 19 - 24)**

PROJECT: 27,35 & 35A HOWE STREET, HOWICK

AMENDMENT SCHEDULE		CLIENT: SING FAMILY TRUST	
A Amend memorandum of Easements	12/15	AUTOCAD: N/14015/autocad/rc/sub	SCALE: 1:600 (A3)
B Amend surrendered easements	12/15	CIVILCAD: 14015.12d	DATE DRAWN: SEPT 2015
		SURVEYOR: BH DRAWN: EHS	14015-02-01B
		DESIGNED: KBA CHECKED: KBA	

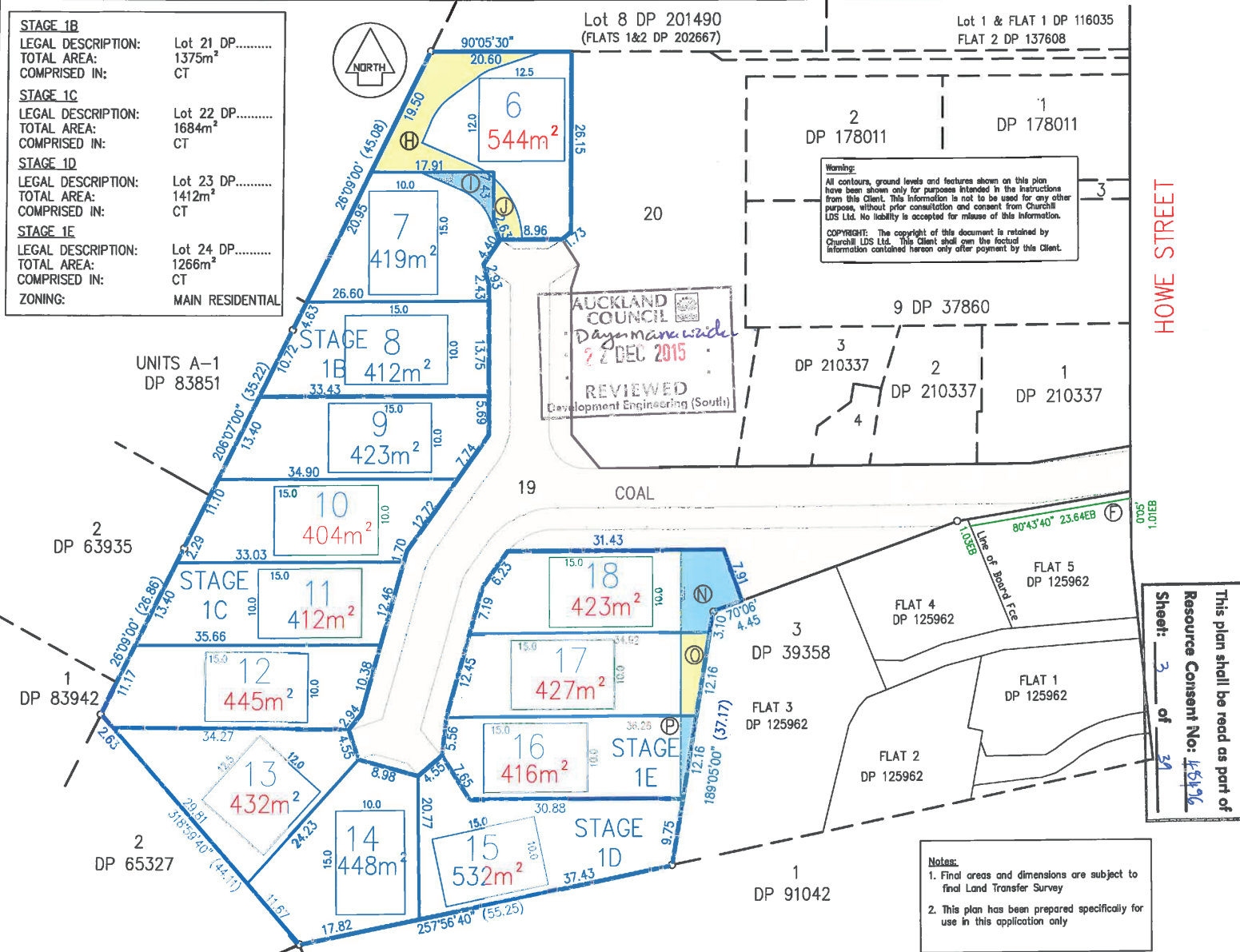

STAGE 1B
 LEGAL DESCRIPTION: Lot 21 DP.....
 TOTAL AREA: 1375m²
 COMPRISED IN: CT

STAGE 1C
 LEGAL DESCRIPTION: Lot 22 DP.....
 TOTAL AREA: 1684m²
 COMPRISED IN: CT

STAGE 1D
 LEGAL DESCRIPTION: Lot 23 DP.....
 TOTAL AREA: 1412m²
 COMPRISED IN: CT

STAGE 1E
 LEGAL DESCRIPTION: Lot 24 DP.....
 TOTAL AREA: 1266m²
 COMPRISED IN: CT
 ZONING: MAIN RESIDENTIAL

27 DEC 2015
 DEVELOPMENT ENGINEERING (SOUTH)

Warning:
 All contours, ground levels and features shown on this plan have been shown only for purposes intended in the instructions from this Client. This information is not to be used for any other purpose, without prior consultation and consent from Churchill LDS Ltd. No liability is accepted for misuse of this information.

COPYRIGHT: The copyright of this document is retained by Churchill LDS Ltd. This Client shall own the factual information contained hereon only after payment by this Client.

HOWE STREET

STAGE 1B

MEMORANDUM OF EASEMENT IN GROSS			
PURPOSE	SHOWN	SERVIENT TENEMENT	GRANTEE
Right Water	(H) (D)	Lot 6 hereon	Auckland Council
	(I)	Lot 7 hereon	Auckland Council

AMALGAMATION CONDITIONS

STAGE 1B
 That Lot 19 DP..... be held as to one undivided one seventeenth shares by the owners of Lots 6, 7 and 8 hereon as tenants in common in the said shares and Individual Certificates of Title be issued in accordance therewith

STAGE 1C

AMALGAMATION CONDITIONS

STAGE 1C
 That Lot 19 DP..... be held as to one undivided one seventeenth shares by the owners of Lots 9, 10, 11 and 12 hereon as tenants in common in the said shares and Individual Certificates of Title be issued in accordance therewith

STAGE 1D

AMALGAMATION CONDITIONS

STAGE 1D
 That Lot 19 DP..... be held as to one undivided one seventeenth shares by the owners of Lots 13, 14 and 15 hereon as tenants in common in the said shares and Individual Certificates of Title be issued in accordance therewith

STAGE 1E

MEMORANDUM OF EASEMENT IN GROSS			
PURPOSE	SHOWN	SERVIENT TENEMENT	GRANTEE
Right to Drain Water	(N)	Lot 18 hereon	Auckland Council
	(O)	Lot 17 hereon	Auckland Council
	(P)	Lot 16 hereon	Auckland Council

AMALGAMATION CONDITIONS

STAGE 1E
 That Lot 19 DP..... be held as to one undivided one seventeenth shares by the owners of Lots 16, 17 and 18 hereon as tenants in common in the said shares and Individual Certificates of Title be issued in accordance therewith

This plan shall be read as part of Resource Consent No: 14/5196
 Sheet: 3 of 21
 CHURCHILL COUNCIL

Notes:

- Final areas and dimensions are subject to final Land Transfer Survey
- This plan has been prepared specifically for use in this application only

Churchill LDS
 surveyors • engineers • planners
 P.O. Box 64 246 Tel: (09) 273 4182
 Botany Fax: (09) 273 4309
 Auckland 2163 Email: admin@cllds.co.nz

SUBDIVISION PLAN
 STAGES 1B, 1C, 1D AND 1E

PROJECT: 27,35 & 35A HOWE STREET, HOWICK

AMENDMENT SCHEDULE	
A Appurtenant easement added	12/15

CLIENT: SING FAMILY TRUST
 AUTOCAD: N/14015/autocad/rc/sub SCALE: 1:600 (A3)
 CIVILCAD: 14015.12d DATE DRAWN: SEPT 2015
 SURVEYOR: BH DRAWN: EHS
 DESIGNED: KBA CHECKED: KBA **14015-02-02A**